



SPYCO ON 3 Hi W

414 353 30 W

AVAILABLE IN

BLACK 414 353 30 B

WHITE 414 353 30 W

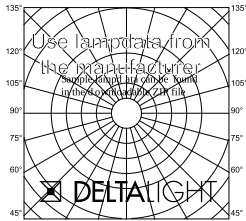
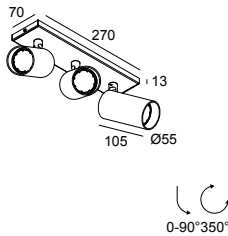

[View on website](#)

General info

LOCATION	indoor
INSTALLATION	Ceiling Surface mounted
INGRESS PROTECTION	IP20
WEIGHT (KG)	1.1
ADJUSTABILITY	0° to 90° swiveling, 350° rotatable

Electrical info

	3 x QPAR51 max.20W
CLASS	II
DIM TYPE	mains (phase cut-off)

Lightsource info

LIGHTSOURCE NAME	GU10
------------------	------

Remarks

lamp not included

For detailed installation instructions, please consult the manual: [414\\_353\\_30\\_HAND.pdf](#)

Notes: